

MIP - 2150 STEEL SAFETY SHEARS

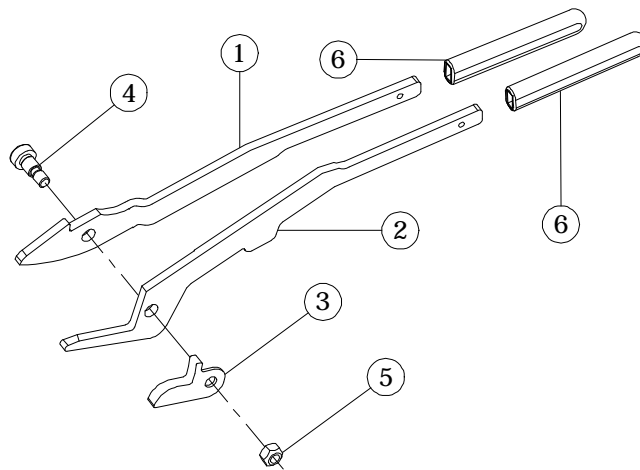

| <u>KEY#</u> | <u>DESCRIPTION</u> | <u>QTY</u> | <u>PART#</u> |
|-------------|--------------------|------------|--------------|
| 1 | Upper Jaw | 1 | M2150-1 |
| 2 | Lower Jaw | 1 | M2150-2 |
| 3 | Strap Guide | 1 | M2150-3 |
| 4 | Pivot Screw | 1 | M2150-4 |
| 5 | Hex Lock Nut | 1 | M2150-5 |
| 6 | Handle Grip | 2 | M2150-6 |

Reference part number when ordering. Read all operating & safety instructions.

OPERATING INSTRUCTIONS

OPERATING INSTRUCTIONS:

1. Place one gloved hand on the strap and position yourself so that you are not in the path of the strapping.
2. Cut the strap several inches away from your hand. The cut should be made so that the flying strap is too short to reach any part of the body.
3. Strapping should be cut squarely, not at an angle, to avoid sharp strap edges.
4. Immediately dispose of all strapping to avoid accidents and injury.

SAFETY WARNINGS:

- Before operating the tool, review the enclosed MIP, Inc. General Hand Tools and Strapping Safety booklet. Only trained personnel should operate MIP, Inc. hand tools.
- Keep fingers away from areas that can pinch or cut. These areas are located at the front of the tool.
- Only use equipment recommended for the strap. The MIP-2150 is recommended only for .015-.035 gauge steel strap, 3/8" – 1-1/4" wide.
- Review the instructions and safety material on a regular basis.
- **Warning:** Improper use may result in blindness, severe laceration, amputation, or death.

